

Radiant Edge HotSlot™ QuickStart Instructions

This is a brief overview of the Radiant Edge HotSlot installation, and is not intended to be a substitute for complete instructions. Contact Summit Ice Melt Systems for the current HotSlot Installation and Operation Guide.

1. System Layout:

Determine layout of system and Heater Cable. Locate junction box and termination End Seal. HotSlot's one-size-fits-all design makes it easy to place your materials order. Be sure to add Heater Cable for gutters and downspouts. Summit Ice Melt Systems will assist in the layout, if necessary.

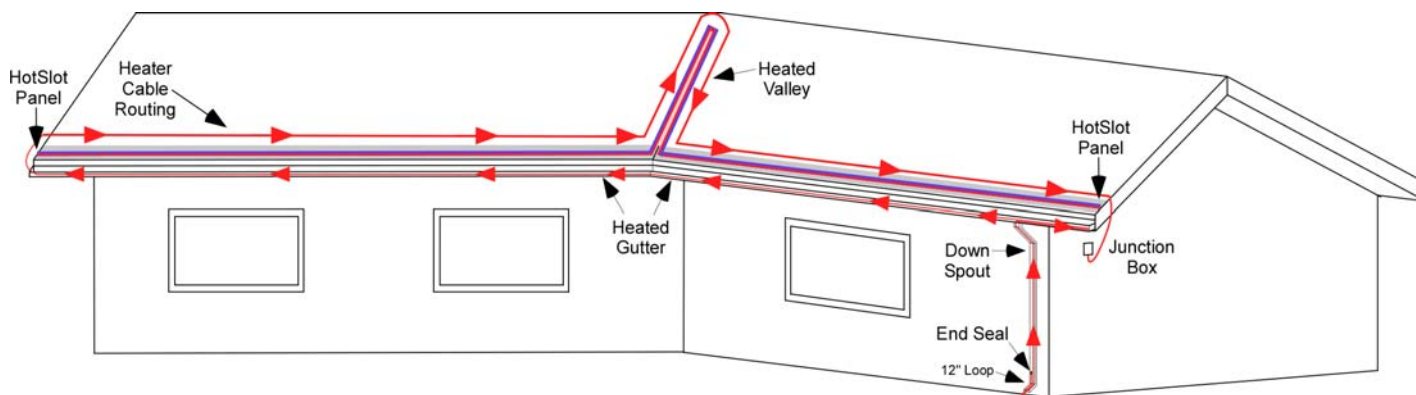

2. Roof Preparation:

Existing shingles: Loosen lap of second course of shingles. Panel and Valley installation is virtually the same whether metal "W" valley flashings or "woven" shingled valleys are used.

New Shingles: Install Panel over ice and water type membrane and strip counterflash top flange of Panel before shingle installation.

Existing Metal: If system permits, cut roofing panels flush to fascia, and remove fasteners to 7" up roof. (Additional prep or alternate system may be required for standing seam and other metal systems).

New Metal: Install Panel over ice and water type membrane and strip counterflash top flange of Panel before roofing installation. Note: an alternate system may be required by certain metal roofing systems.

3. **HotSlotPanel Installation:** Install the 8' panels at the roof's edge while tucking under the second course of shingles. Attach with screws through pre-drilled holes for fast installation. Miter cuts and sizing may be done with a carbide-tipped circular saw.

4. **Valley installation** (if applicable): Clean valley area; embed Valley Base extrusion into adhesive. Do not penetrate with fasteners.

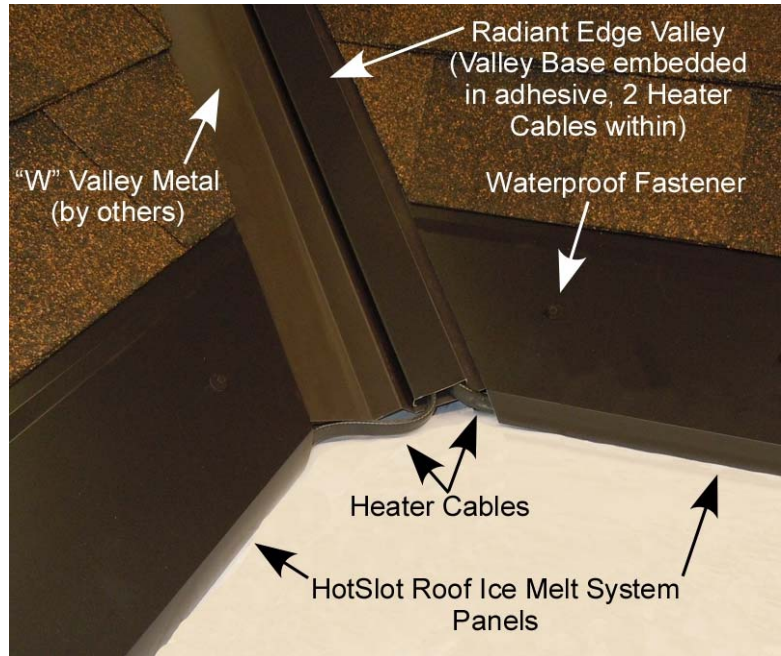

5. **Heater Cable Installation:** Install End Seal on Heater Cable and insert through HotSlot system. At valleys install Heater Cable up one slot and return down the other slot. Continue installing remaining Cable along adjacent eave. Press Heater Cable into slot until fully seated. Install matching snap-on cover to Valley Base to cover cables.

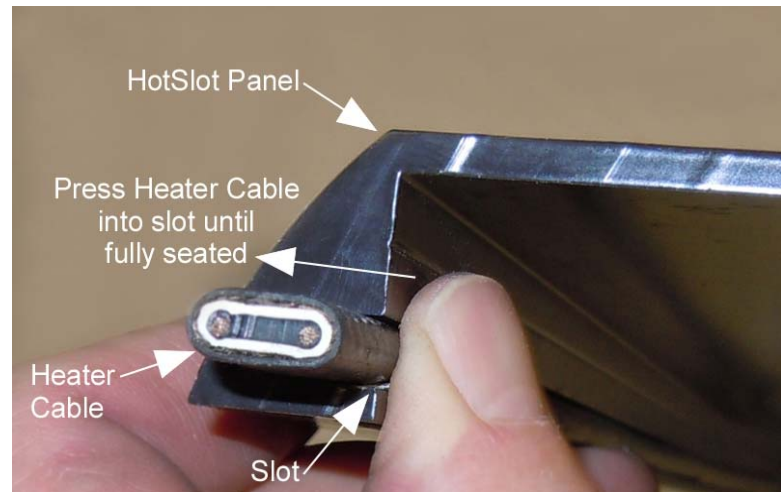

6. **Test and connect:** Connect Heater Cable to junction box with Power Connection Kit. Connect to controller, if applicable. Conduct final testing, connect to protected circuit. The HotSlot ice melt system **MUST** be protected with a ground fault protection device per local codes and the NEC (National Electric Code) and CSA (Canadian Standards Association).

7. **Operation:** Turn on system before a storm begins. Remember it is much easier and more energy-efficient to prevent ice from freezing that it is to melt it. Our UL Rated Heater Cables are self-regulating and will never overheat. Heat is generated only when it is needed, and precisely where it is needed.

Summit Ice Melt Systems, Inc.

2911 Lake Forest Road, PO Box 6928, Tahoe City, CA 96145 Ph: 530-583-8888 Fax: 530-583-7777
summiticemelt.com info@summiticemelt.com